



106 Mill Court

Ashford, TN24 8DP

Price £335,000

A spacious townhouse enjoying a wonderful open outlook, just a short walk from Ashford town centre and mainline train station.

The property comprises an entrance hall, cloakroom, kitchen, dining room, family room extension, sitting room, three bedrooms, en suite and family bathroom.

The rear garden is pleasantly enclosed with the property benefitting from gas central heating, double glazing and off road parking.

NO ONWARD CHAIN.

Viewing

Please contact our Ashford Office on 01233 646411 if you wish to arrange a viewing appointment for this property or require further information.

- SOLD BY GOULD HARRISON
- OPEN OUTLOOK TO FRONT
- THREE BEDROOMS
- EN SUITE & FAMILY BATHROOM
- TWO RECEPTION ROOMS
- SHORT WALK TO TOWN & STATION
- OFF ROAD PARKING
- NO ONWARD CHAIN
- EPC RATING - C (71)



3



2



2



C

Floor Plan

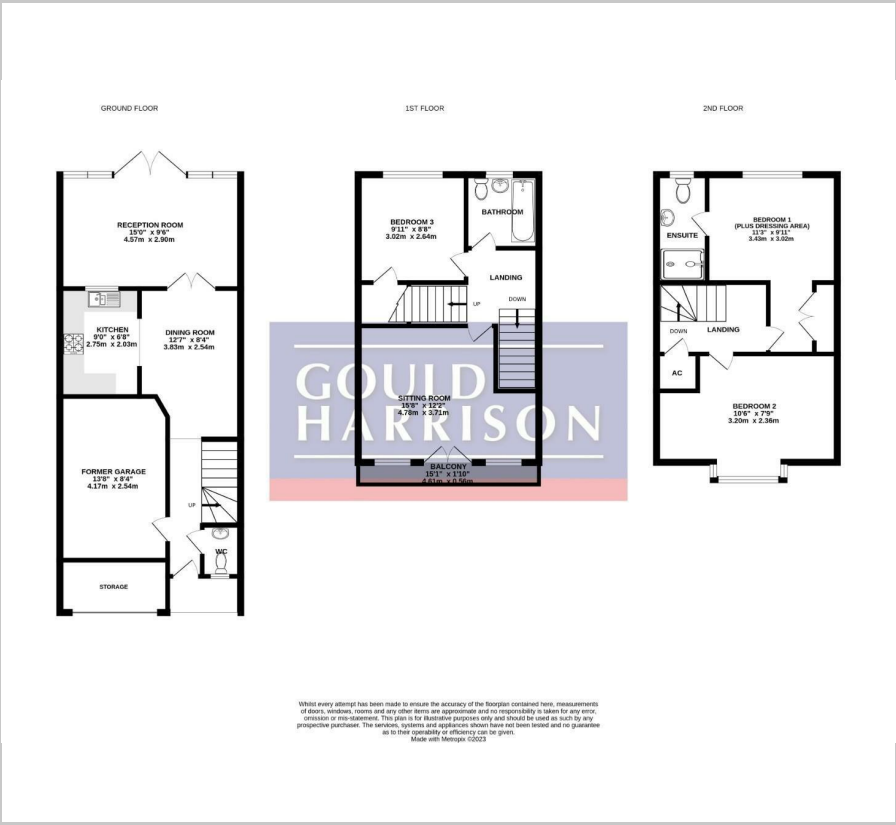

Area Map



Energy Efficiency Graph

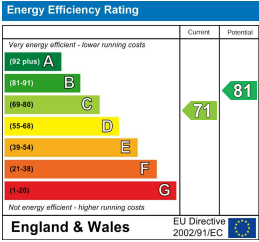

These particulars, whilst believed to be accurate are set out as a general outline only for guidance and do not constitute any part of an offer or contract. Intending purchasers should not rely on them as statements of representation of fact, but must satisfy themselves by inspection or otherwise as to their accuracy. No person in this firm's employment has the authority to make or give any representation or warranty in respect of the property.